

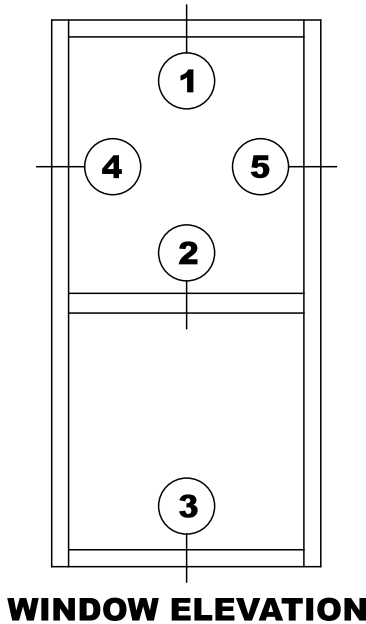

TH-5250 SERIES

2 1/2" MAIN FRAME
 FIXED OVER FIXED
 1" INSULATED GLAZING

FOR COMPLETE SELECTION OF DRAWINGS FOR THIS WINDOW SERIES
 PLEASE CONTACT US EITHER BY E-MAIL, ENG-DEPT@TMIWINDOWS.COM
 OR BY CALLING THE ENGINEERING DEPARTMENT AT 908-810-0030



WINDOW ELEVATION

HEAD ①

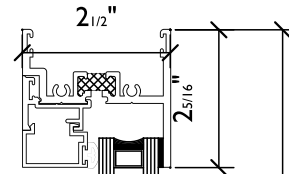

INTEGRAL ②

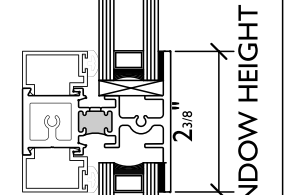

SILL ③

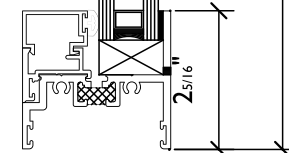

JAMB

④

JAMB

⑤

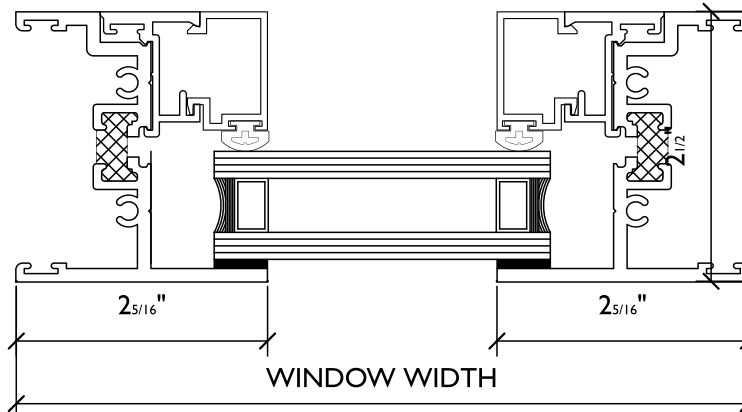

WINDOW WIDTH